



**THE SCAFFOLDING SPECIALISTS
OFFSHORE & ONSHORE**

NIL SATIS NISI OPTIMUM

contents

| | |
|----|---------------------------|
| 4 | who we are |
| 6 | our scope of operations |
| 8 | projects |
| 10 | 3D designs |
| 12 | events |
| 16 | safety awareness |
| 18 | equipment & tools |
| 26 | managing director message |



WHO WE ARE

A.P. Scaffolding Solutions was founded in 2009, specializing in access scaffolding services, being installations and rentals.

We are based in Cyprus and perform projects both onshore and offshore. Through time we have gained the trust of the market and have become pioneers in the field of scaffolding services.

We have invested without hesitation in 3D CAD software, implemented by our in-house engineering team to present to our customers for complex diverse or custom-made designs. Our production teams always follow the time schedule and deadlines for the delivery of projects for our customers, working under pressure, with efficiency and

quality to deliver the desirable results.

All our scaffolders are fully trained both overseas and within our company and follow strictly the international and European procedures of erection and dismantle working as a close-knit team. Regular trainings and toolbox talks are performed throughout the year.

In our offices and yards, we have a large volume of scaffolding, forklifts, trucks with cranes company lorry trucks and vans to accommodate all our customers efficiently. Our prompt response and impeccable reputation within the construction, industrial, offshore oil and gas sector has increased over the years. Our administration office



and production management have accomplished in handling projects and contracts with dedication and as a result the number of our clientele keeps increasing throughout the years. Finally, we would like to emphasize that we constantly urge and motivate our staff to deliver the best service possible with the best conduct, and as we say in Scaffolding Solutions “Nil Satis Nisi Optimum”, never satisfied unless it is the best!





OUR SCOPE OF OPERATIONS

Based in Cyprus, we are in a position to provide services in the wider Mediterranean and Europe area.

Whether on land or at sea, on boats and platforms, at heights or underground areas, we are always ready and able to meet your access demands.

Scaffolding Solutions is able to undertake access - scaffolding projects in the following fields:

- Power stations
- Refineries
- Marine shipping yards
- Oil and gas drilling platforms
- Civil and construction sites
- Events



PROJECTS







3D DESIGNS

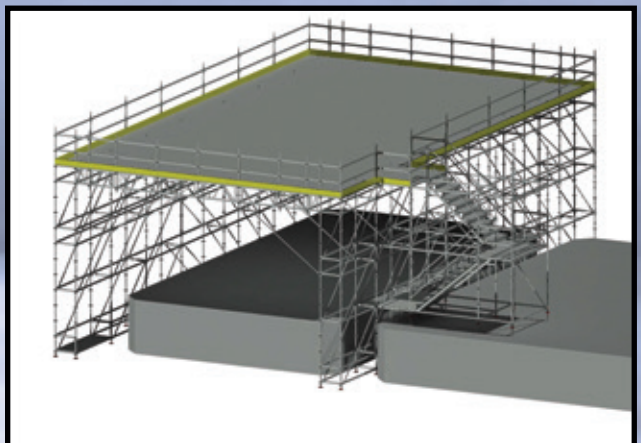
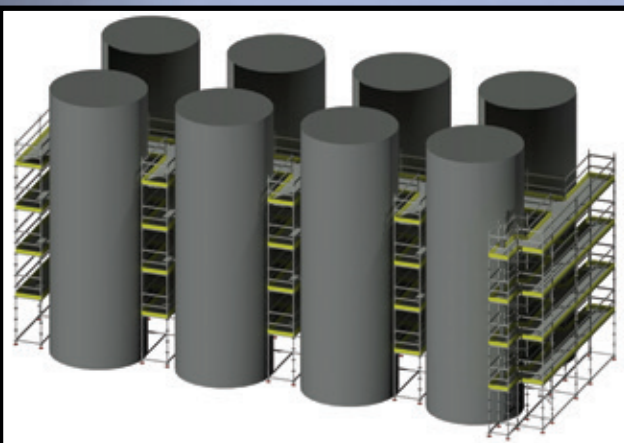
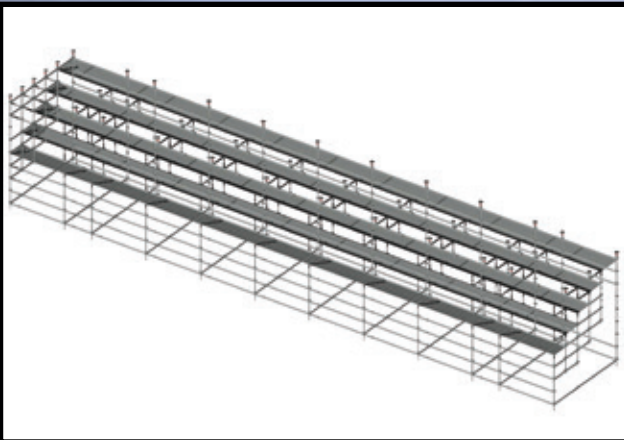
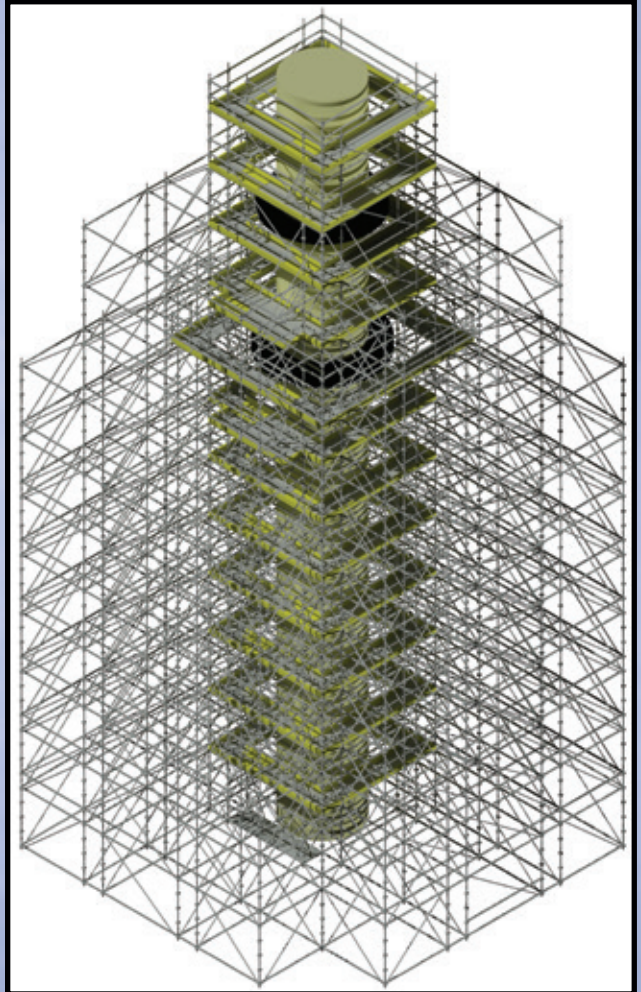
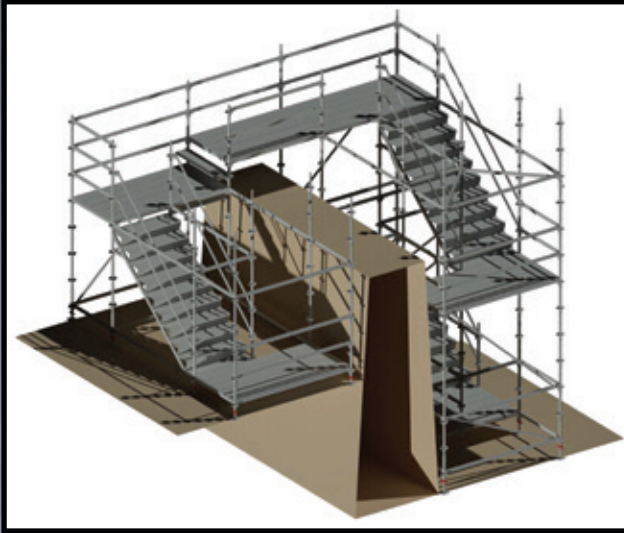

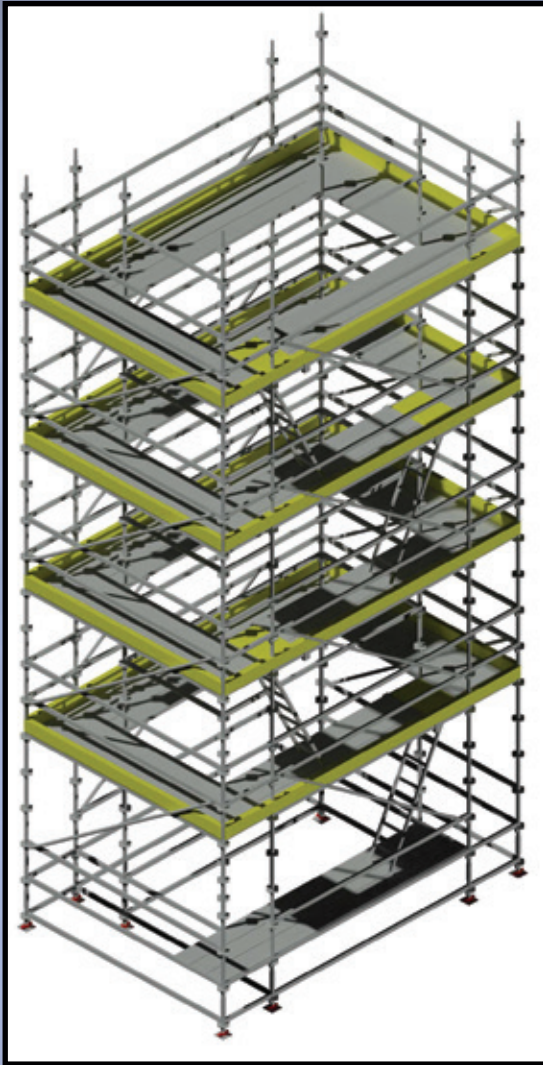

“A 3D design can easily show dimensions in 3D space of objects and their relationships. We believe that 3D designs help our customers in visualizing the structures and aids in the communication between both parties to reach the best design possible.”





Fengaros Festival



Loud Music Festival CY



Living Color Music & Arts Festival



Protaras Summer Film Festival

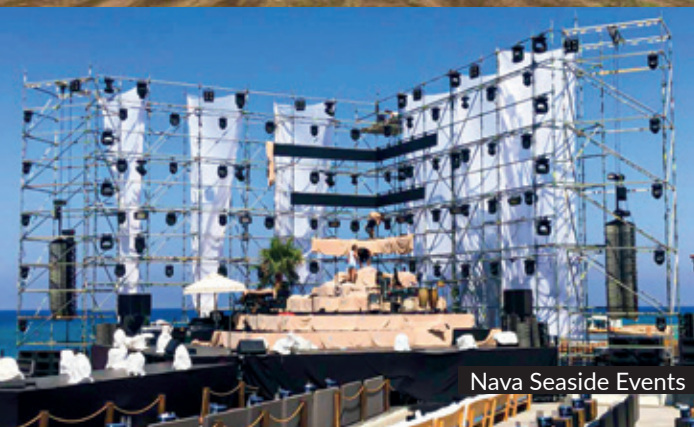

Nava Seaside Events

EVENTS

Having established a trustworthy and reliable reputation within the sector of the entertainment field, we have built up ongoing collaborations.

Being known for **#entertainmentwithsafety** we can accommodate and be of service for the construction of background stages for many music festivals and concerts.

Safety requirements are of high importance for such events, especially for the custom designed stages.

We take our part very seriously within this area and smoothly cooperate with the teams that involve load bearing materials, being large sound systems, visual and LED screens and lighting systems.

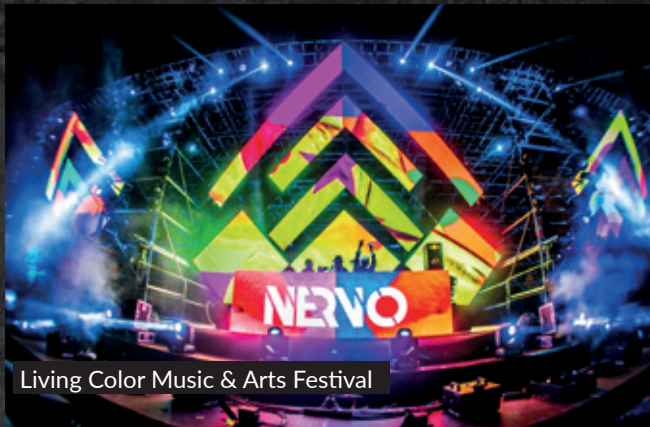

SPORT EVENTS



Cyprus 3 ON 3



Cyprus 3 ON 3



Logicom Cyprus Marathon



Dorians Coastal Challenge

A.P. Scaffolding Solutions Ltd promotes and strongly supports sport events as part of its social contribution. We believe and encourage fair play, sportsmanship and healthy competition. Throughout time we have supported many sport and athletic events by installing sitting areas, placing barriers and constructing towers to place various assisting items for the sports events.

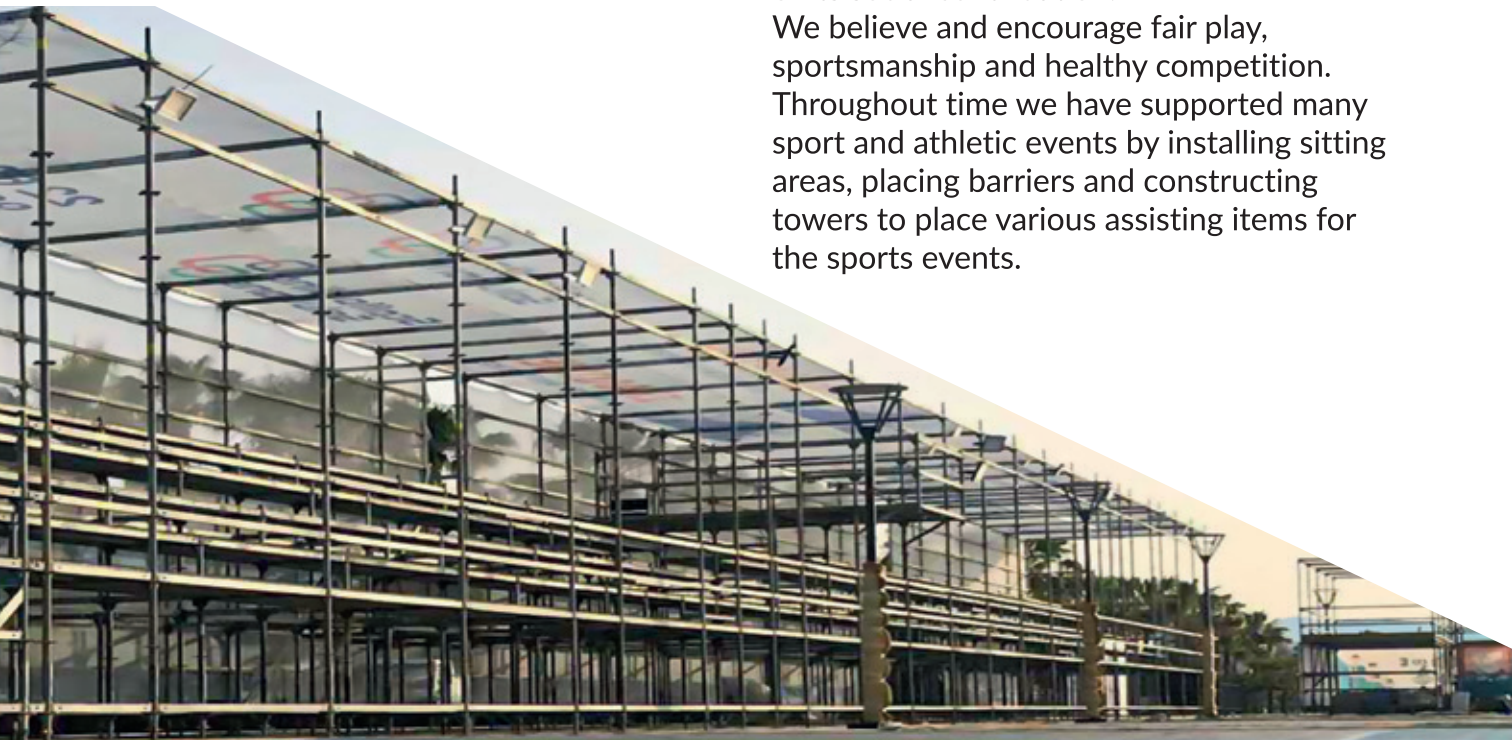

Dorians Coastal Challenge



“NO ONE GETS HURT”

SAFETY AWARENESS

Safety is of paramount importance to us and our clients. We encourage a pro-active commitment to Health and Safety at all levels and an intolerance of behavior and work practices that increase the risk of accidents and damage to health.

We share our health and safety information and expertise along with our customers and work with customers to improve all round Health and Safety performances.

As part of this we have implemented a complete H.S.E. management system and we have been accredited with ISO45001:2018 certification regarding our Occupational Health and Safety management system.

“

HEALTH & SAFETY STATEMENT

OUR GOAL: “NO ONE GETS HURT”

”

The Management of Scaffolding Solutions is committed to the health and safety of its employees and for all who are involved in our projects. Protection of employees from injury or occupational disease is a major continuing objective. We are committed to continuing improvement towards an accident-free workplace through effective administration, education and training. All supervisors and workers must be dedicated to the continuing objectives of eliminating the “near misses” which will greatly reduce the risk of injuries.

Our philosophy is that the well-being of our company and clients depends on the health and safety of our workforce. The Directors and Officers of this corporation promise that every precaution reasonable in all circumstances will be taken for the protection of all workers. No job is to be regarded so urgent, that time cannot be taken to do it in a safe manner. The welfare of the individuals is our greatest concern.

Supervisors will be responsible for the health and safety of workers under their supervision. Supervisors are responsible to ensure that machinery and equipment required for use by each worker are safe and that each worker works in compliance with established safe work practices and procedures for each piece of equipment. Workers must receive adequate training in their specific work tasks to protect their health and safety.

All supervisors, employees and subcontractors must protect their own and fellow workers' health and safety by working in compliance with the Occupational Health and Safety Act and all applicable regulations and safe work practices and procedures established by our company.

We recognize that a safe work environment can be established and sustained only through a united effort by all employees and subcontractors and that the assistance of each person is required. Your attitude and cooperation in promoting accident prevention will assist in achieving our goal: “no one gets hurt” and make our company the best place to work, one where employees share in corporate growth and success.

Everyone from the Director to new workers has the responsibility to ensure a safe and healthy workplace. Let's all work together to prevent incidents from creating unwanted losses and personal injuries or illnesses.

Andreas Polydorou
Managing Director



EQUIPMENT & TOOLS

Our aim is to serve our clients with the safest and most innovative method of scaffoldings and access solutions. In order to achieve that we have gained exclusive agency and distributorship of various brands such as Altrex and Rhino Shrink Wrap.

Scaffold Tube

Galvanised, Aluminium, High Yield Scaffold Tube



Scaffold Boards

BSI 1.2m - Fire Proof Scaffold Boards - Kiln Dried Scaffold Boards - Plastic Battens - Plastic Scaffold Boards - Laminated Scaffold Boards - Sole Boards (Timber)



Scaffold Fittings

Doubles - Swivels - Ladder Clamps - Singles - Joints - Girder Coupler - Roofing Coupler - Board Retainer - Base Plate - Pressed Sleeve - Tube Clamps



EQUIPMENT & TOOLS

System Scaffold

Peri Up Flex Scaffolding

Peri Up Flex Modular Scaffolding can be used for realizing robust, high load-bearing facade scaffolds. The decking is mounted directly on the ledgers while the bay lengths are adjustable in 25 cm increments. Connecting other system components to the standards is possible using 50 cm node spacings.

The integrated lock against lifting along with

the Gravity Lock for the ledgers accelerate assembly operations. Optionally, the ledgers are mounted in advance from a safe position. Extremely adaptable. Adjustments are carried out in a uniform grid arrangement of 25 cm which provides a high level of flexibility for complex facade scaffolding. Gap-free decking levels and a high load-bearing capacity.

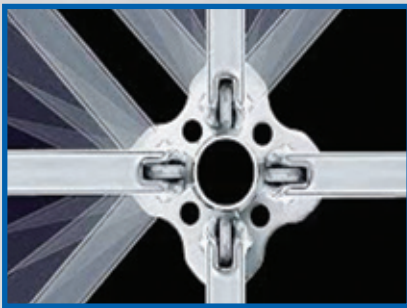

Temporary Roofing Systems

UBIX is the Class leading temporary roofing system. In service over a period of 14 years, UBOX has proven itself again and again as being the first choice temporary roof system for many experienced scaffold companies.

This excellent temporary roof system is based on kader sheet covering, quick and simple to erect using a small number of standard

components which enables the client to achieve maximum weather protection in a quick, safe and economical method. The Ubix temporary roof system has the capabilities to span up to 40 metres using standard beam configurations and even larger structures and spans can be achieved with bespoke designed equipment.



EQUIPMENT & TOOLS

Beams

Aluminium - Steel Ladder Beams - X Beam



Combisafe

Combisafe Prevention

SMB S System - SMB C System - Net Barrier System, Combisafe Protection Safety Net Fan - Alsipercha - Loading System - Personal Protective System

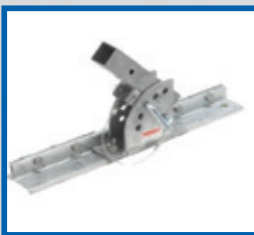

Safety Equipment

Loading Bay - Ladder Safety Hatch - Self Closing Ladder Safety Gate



EQUIPMENT & TOOLS

Staircases

Peri Up Flex Stair

The lightweight aluminium flights of stairs with 75 cm widths are mounted on ledgers of the PERI UP modular scaffolding. This results in 4-legged stair towers with alternating staircase units or staircase units in the same direction with heights of up to 100 m. The PERI UP Flex Stair 75 is designed to accommodate 2.00 kN/m² loads and serves as access to working areas or construction sites. Flexible assembly through the 25 cm grid dimension. All bays can be completely closed even in the smallest of spaces. Easily adapted for accessing building openings with brackets and small flights of stairs – regardless of storey heights.

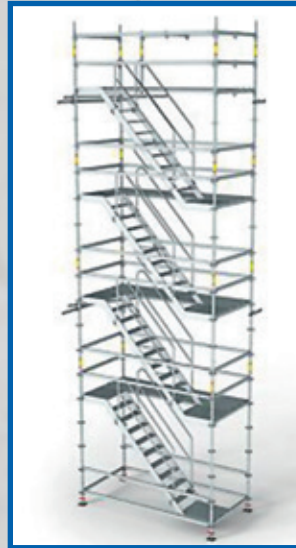

Temporary Fencing, Hoarding, Barriers



ALUMINIUM TOWERS, LADDERS, STEPLADDERS, CONSOLES, RAKCS AND PLATFORMS

Altrex Rolling System Towers

MiTower & MiTower Plus

Lightweight, easy to transport and store
Wooden or lightweight Fiber-Deck® platforms

Mi Tower:

- Ideal for 1 person usage
- Maximum Working Height at 6.20m
- Dimensions: Width: 0.73m / Length: 1.17m

MiTower Plus:

- Ideal for 2 person usage
- Maximum Working Height at 8.20m
- Dimensions: Width: 0.73m / Length: 1.62m



Tower RS5 (RS51 & RS52)

- Light-weight Fiber-Deck® platforms
- Double braked wheels 25 cm adjustable
- Load of 250kg per platform
- Maximum working height at 14.20m
- Dimensions:

RS 51: Width: 0.75x Length: 2.45 m

RS 52: 1.35x2.45m



RS44

Power single width folding tower

- Single width folding/rolling tower, ideal for narrow spaces
 - Foldable and compact to store and transport
- Dimensions: Width: 0.75m / Length: 1.85m



Altrex Ladders, Stepladders

Folding Ladder

- For intensive and professional use
- Multifunctional - Telescopic
- Stable due to flared beams
- Maximum weight for:
Little Giant: 22.5kg
Little Giant Black Pro: 23.6kg



Rocky

- Spreading lock prevents unexpected closure of the ladder
- 3-part Rocky is easy to handle a long the façade thanks to top rollers



TL Smart Art Pro

- Unique integrated wall support
- Safe unlocking with soft close technology

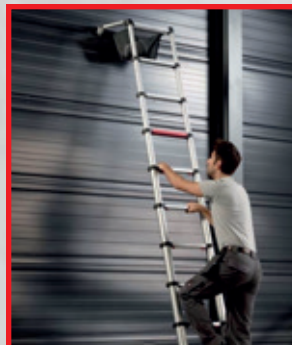

Extension Console

- Full accessibility to various roof types / - Safe and stable /
- Suitable for RS TOWER 5 Series scaffolds



Rolguard Stepladder

- All-round protection, extra safety
- Extra-large working platform, more standing comfort
- Equipped with wheels for easy transport



X PRO® Stepladder

- Stepladder and work bench in one
- Robust, functional and unique design
- Patented hinge system for increased stability



Scaffold Rack

- Easily store and transport your scaffolding
- For narrow and wide rolling towers
- Prevents damage to your scaffolding during transport



Suspended Platforms

- Available with end or walk-through stirrups / - Stable, strong and reliable /
- Modular system, many possible configurations / - Up to 21 metres in length

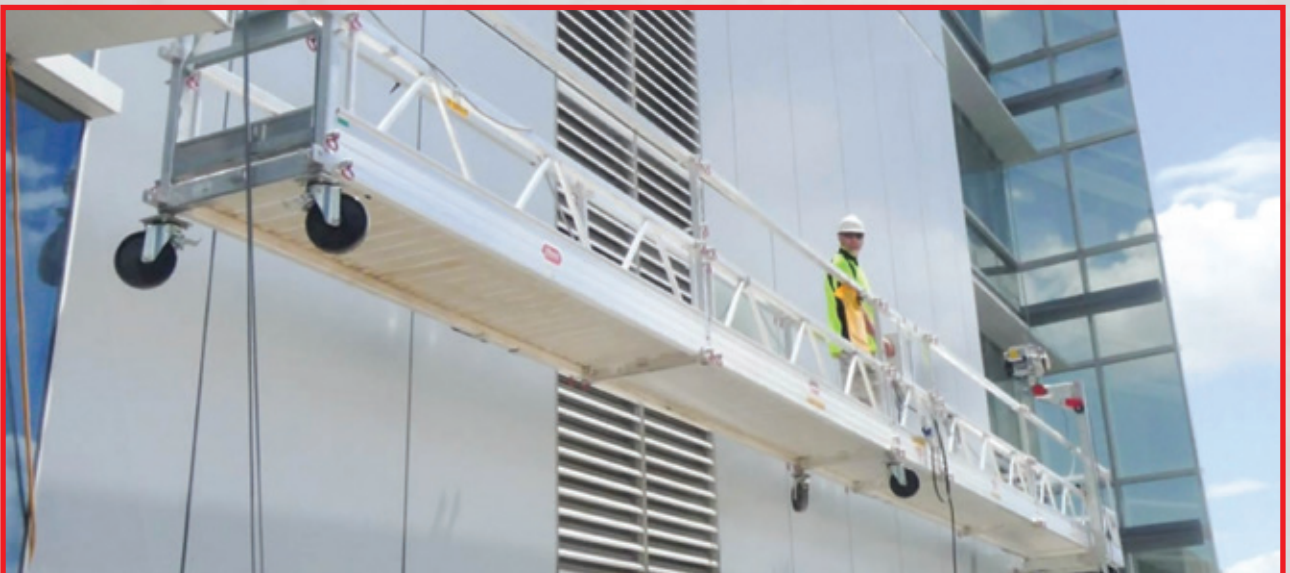



**Temporary Weather Protection
& Containment**

Shrink wrap sheeting is typically used as an alternative to conventional scaffold sheeting in order to encapsulate scaffold cladding for the temporary weather protection or containment of construction work.

It is typically chosen by scaffolders or contractors who need a more robust scaffold sheeting that will not detach in strong winds or become loose and saggy over time. Shrink wrap is heat shrunk 'drum tight', with heat sealed joints between sheets creating a smart & professional cladding that moulds very tightly around the scaffolding. The completely sealed skin around a work area protects it from adverse weather conditions, or the surrounding environment from hazardous residues from within.

- Scaffold Wrapping
- Blast Containment
- Internal Partitions
- Building Screens
- Temporary Roofs



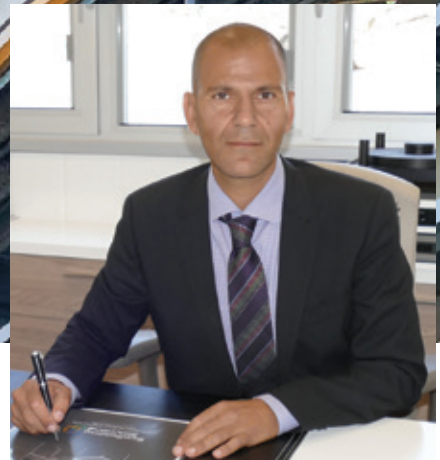

Managing Director Message

Being able to provide scaffolding access services at heights with safety takes serious work and responsibility.

The Scaffolding Solutions team, starting from the management and site workforce, have spent hours of attending training programs both abroad and in-house from overseas training institutions in order to reach the satisfying levels and knowledge of scaffolding erection and dismantle.

In our course of acquiring these certificates of qualifications, we have invested without hesitation in concern to time and financial costs.

Our operations over the years have increased both in volume and in different areas. All members within the company having the same vision and teamwork spirit has helped us reach desirable results. The nature of our clientele consists of: construction, industrial, shipping, offshore and onshore scaffolding works, oil and gas, confined spaces, events being mainly the construction of stages for musical festivals and large concerts and sport events being sitting arenas for spectators. Our scaffolding solution services family also includes a very important collaboration for which we are proud of, the very successful and easy to handle ALTREX aluminum tower access scaffoldings, for which we are the sole traders and distributors in Cyprus.

The Rhino Shrink Wrap is also a very important collaboration, for which we are suppliers and installators. It is used jointly with scaffolding to separate internal partitions, building screens, temporary roof, scaffold wrappings and blast containment. To be able to accomplish all of the above, Scaffolding Solutions has invested in a vast volume of scaffolding material.

A very important achievement I consider, is the acquiring of the ISO45001:2018 certification regarding our Occupational Health and Safety management system and the ISO9001:2015 for our Quality Management System in supply, erection, rent and dismantling of scaffolding. Everybody in the company is working hard and with commitment within their area of expertise thus gaining the satisfactory result in being approved for the ISO certifications. I would like to convey my warmest thanks and gratitude to everyone for this achievement.

In the meantime, I would like to take this opportunity and express our enormous gratitude to our customers, associates and collaborators for putting their trust in our company over the years. We commit in always providing the best quality possible with safety!

Andreas Polydourou
Managing Director



Scaffolding Solutions

THE SCAFFOLDING SPECIALISTS
OFFSHORE & ONSHORE

Head Office:

Tseriou 47, 2572 Pera Chorio Nisou, Nicosia, Cyprus
Postal Address: P.O.Box 12919, 2253 Latsia, Nicosia, Cyprus
Tel.: +357 22 621072, Mob.: +357 99 224567
Emergency: +357 99 776077, Fax: +357 22 622038
E-mail: info@scaffolding-solutions.com.cy
Website: www.scaffolding-solutions.com.cy

